

PUMPER BODY

Long Aluminum 2nd Gen Pumper

CHASSIS

Enforcer Chassis

CHASSIS AXLE, FRONT, CUSTOM

19,500 Lb TAK-4 Axle

AXLE, REAR

27,000 Lb Dana Axle

ENGINE

380 HP Cummins L9 Engine

TRANSMISSION

Allison 5th Gen, 3000 EVS P

BUMPER

22" Extended Steel Pointed

CAB

7010 Enforcer Cab

BODY WATER TANK

750 Gallon Poly Water Tank

COMPT, PUMPER, REAR

51.25" FF RollUp Rear Compt, 41.88" Deep FLush Rear

COMPT, PUMPER, DRIVER SIDE

161" Lap Full Height & Depth Front & Rear

COMPT, PUMPER PASS. SIDE

161" Lap Full Height Front & Rear FDLER

FIRE SUPPRESSION PUMPHOUSE

45" Control Zone Top Mount

PUMP

1250 GPM Waterous CSU

CROSSLAYS, 1.50"

1.50" Crosslays Not Required

CROSSLAYS, 2.50"

2.50" Crosslays Not Required

SPEEDLAYS

(2) 1.50" Standard Capacity

(1) 2.50" Standard Capacity

GENERATOR

Generator Not Required

Foam System

Foam System Not Required

Foam Cell

Foam Cell Not Required

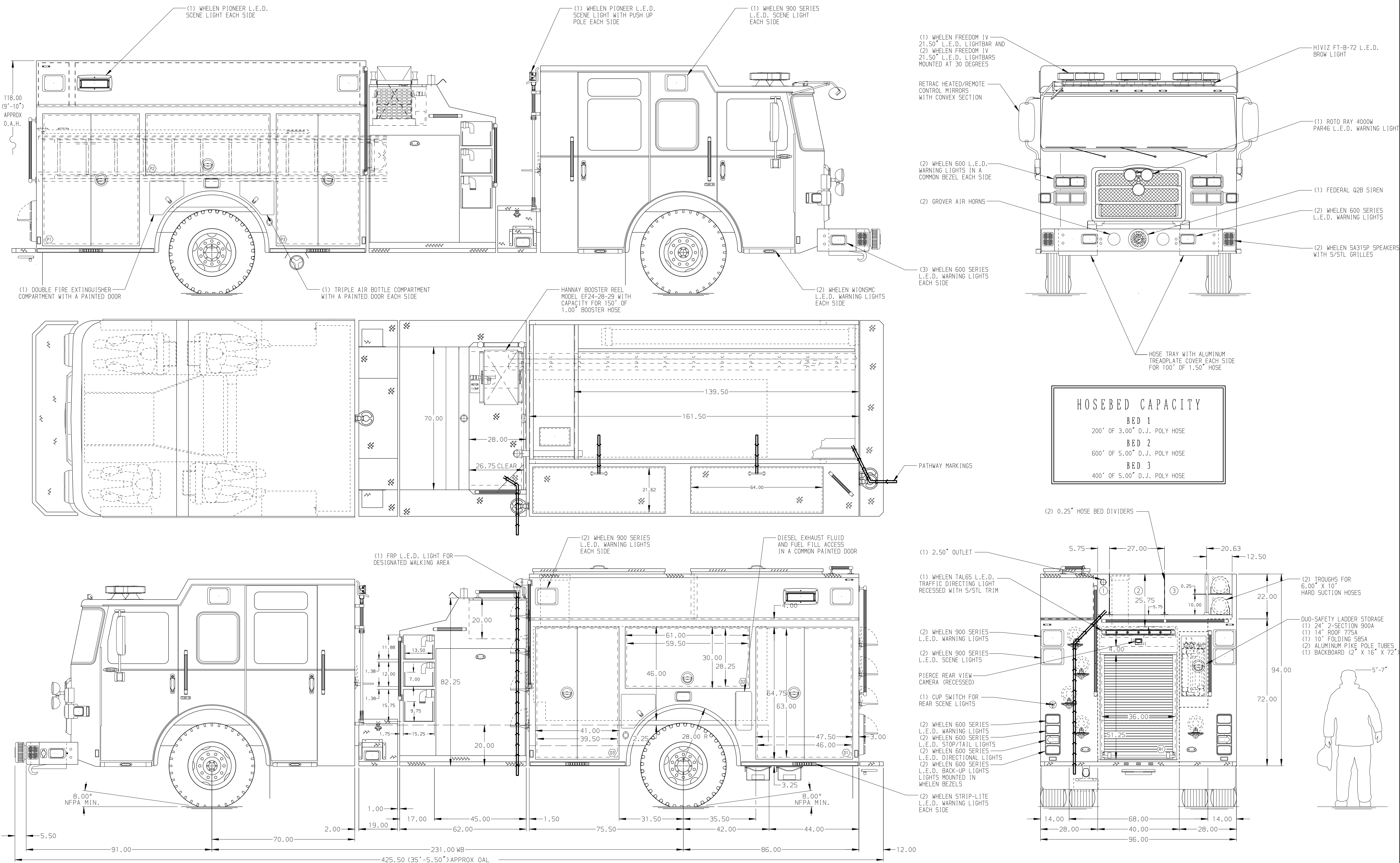

HOSEBED CAPACITY	
BED 1	200' OF 3.00" D.J. POLY HOSE
BED 2	600' OF 5.00" D.J. POLY HOSE
BED 3	400' OF 5.00" D.J. POLY HOSE

NOTE
DIMENSIONS SHOWN ARE APPROXIMATE AND ARE SUBJECT TO MINOR DEVIATIONS AS MAY OCCUR OR BE NECESSARY IN CONSTRUCTION. MINOR DETAILS NOT SHOWN.

- ONE 1.50" OUTLET WITH 2.00" PIPING AND SHIVEL LOCATED IN LEFT AND RIGHT BUMPER TRAYS
- SHRELINE RECEPTACLE WITH KUSMAUL SUPER AUTO-EJECT LOCATED ON DRIVER SIDE BUMPER EXTENSION
- AIR INLET WITH DISCONNECT COUPLING ON DRIVER SIDE BUMPER EXTENSION
- BATTERY CHARGER LOCATED IN COMPARTMENT D3
- BATTERY CHARGE INDICATOR LOCATED ON D.S. SEAT RISER
- TWO 120V DUPLEX RECEPTACLES LOCATED IN CAB
- ONE FLOOR MOUNTED SLIDE-OUT TRAY LOCATED IN COMPARTMENTS D1, P1, & R1
- ONE ADJUSTABLE SHELF LOCATED IN COMPARTMENTS P1 & P3; TWO IN D1
- ONE ADJUSTABLE SLIDE-OUT TRAY LOCATED IN COMPARTMENTS D3 & R1
- ONE TILTING/SLIDE-OUT TRAY LOCATED IN COMPARTMENTS D2 & D3
- ONE SWING OUT TOOLBOARD WITH PAC TRAC LOCATED IN COMPARTMENT P2
- PAC TRAC LOCATED PER SHOP ORDER
- VERTICAL PARTITION LOCATED IN COMPARTMENT D1
- PARTITION BETWEEN COMPARTMENTS D1/R1 AND P1/R1
- ONE SLIDE OUT TOOLBOARD WITH PAC TRAC LOCATED IN COMPARTMENT D1

REV	DATE	BY	CH	ENFORCER
1	11OCT16	COL	JGO	PIERCE
2	16SEP16	COL	JGO	PIERCE

		JOB NO.	30545
		SCALE	DATE
TITLE	Pierce Pumper Approval Drawing		
MAKE	-		
FOR	Holly Springs Fire Rescue		
DWG NO.	30545AD		
CHECKED BY	COL	DRAWN BY	31AUG16
SHEET SIZE	D	CHECKED BY	KB0 02SEP16
		SHEET NO.	1 OF 1